

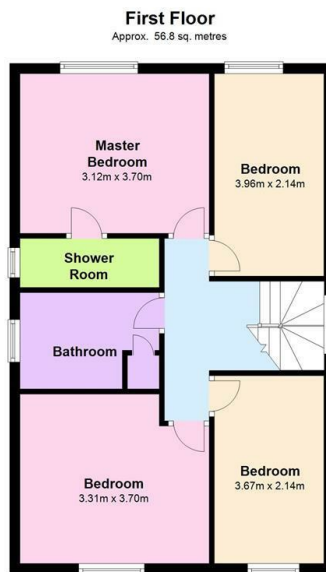

## 63 Rawsley Drive, Kenilworth, CV8 2NX

£1,700 PCM

- 4 Bed Detached House
- EPC Rating C
- Front Driveway & Garage
- Available 13th January 2025
- Bathroom & Ensuite
- Gas Central Heating with Combi Boiler
- Attractive Location
- Lounge & Dining Room
- Fitted Kitchen with Appliances
- Front & Rear Gardens



Total area: approx. 124.3 sq. metres

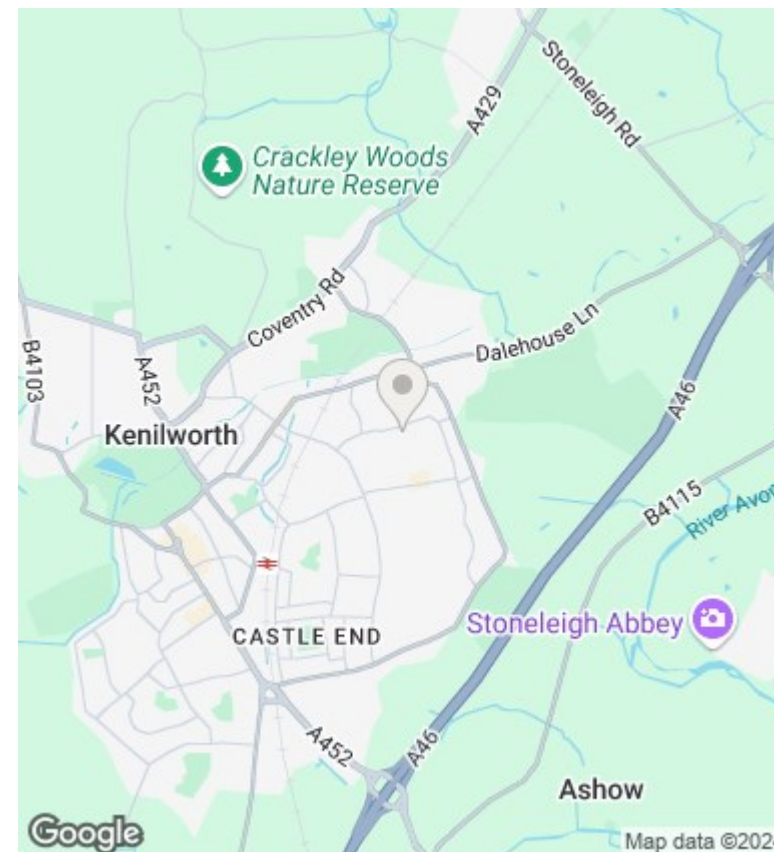

## Directions

## Viewings

Viewings by arrangement only. Call 01926 857244 to make an appointment.

## Council Tax Band

E

## EPC Rating:

C

Energy Efficiency Rating		Current	Potential
<i>Very energy efficient - lower running costs</i>			
(92 plus)	A		86
(81-91)	B	73	
(69-80)	C		
(55-68)	D		
(39-54)	E		
(21-38)	F		
(1-20)	G		
<i>Not energy efficient - higher running costs</i>			
<b>England &amp; Wales</b>		EU Directive 2002/91/EC	